

Material Features:

- High-pressure die-casting aluminum body, treated with electrostatic powder spraying
- High temperature-proof silicon gasket, Tempered safety glass
- High purity aluminum reflector treated with anodized oxidation

Applicable places:

- Illumination of the Urban Roads, Highways, Over-head Roads, Bridges and Residential Layouts etc.

IP65 Class I    

ELZD792-I

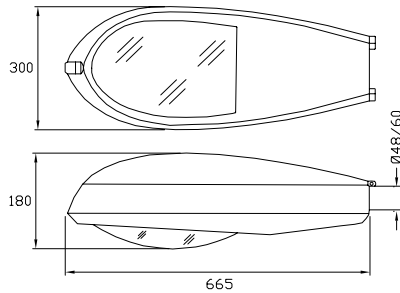

Light Distribution Curve (Cd/1000lm)

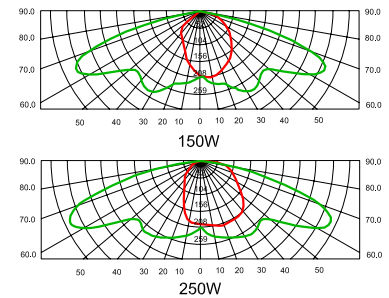

ELZD792-II, III

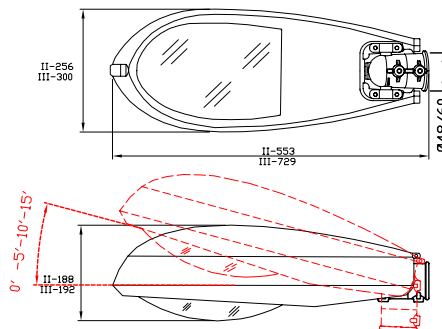

Light Distribution Curve (Cd/1000lm)

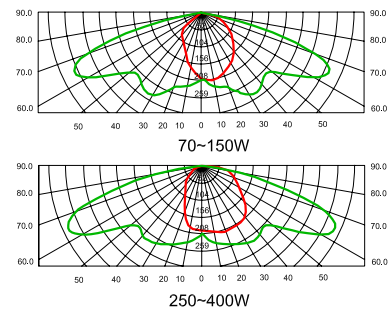

ELZD863

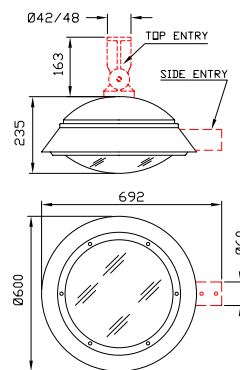

Light Distribution Curve (Cd/1000lm)

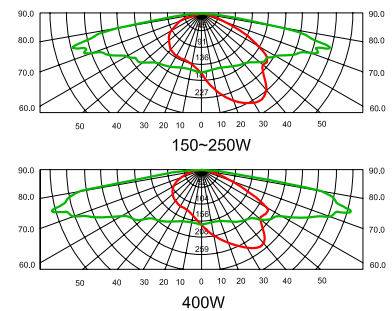

Model No	Light Source	Power W	Power factor pf	Input Voltage V/Hz	Lamp Type	Lamp Life Hr
ELZD792-I	HPS/MH	150~250	>0.85	220~240V/ 50-60Hz	E40	24000 / 12000
ELZD792-II, III	HPS/MH	70~150 250~400	>0.85	220~240V/ 50-60Hz	E27/40	24000 / 12000
ELZD863	HPS/MH	150~400	>0.85	220~240V/ 50-60Hz	E40	24000 / 12000